



**ARGANI
VERRICELLI**

41057-SPILAMBERTO
MODENA-ITALY
Via S.Vito 221
www.tmawinches.com
Tel. +39(059) 78.17.11
Fax +39(059) 78.16.06

TECHNICAL DATA SHEET

MODEL: RECOVERY WINCH TMT-250-160S-3-DP

CODE: 9021854

Doc. N° **M-27**
Pag. 1 di 1
Rev. N° 0
Data Rev. 01/07/14

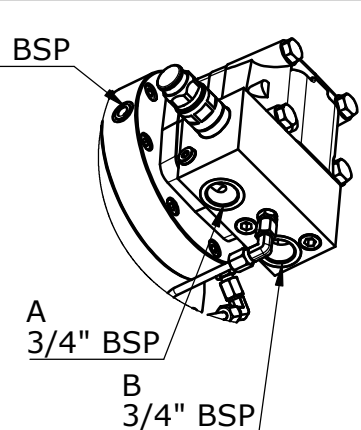
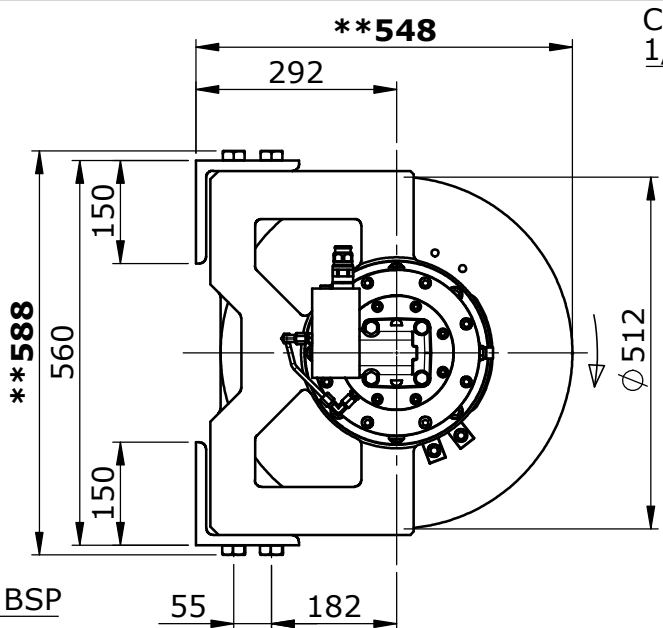
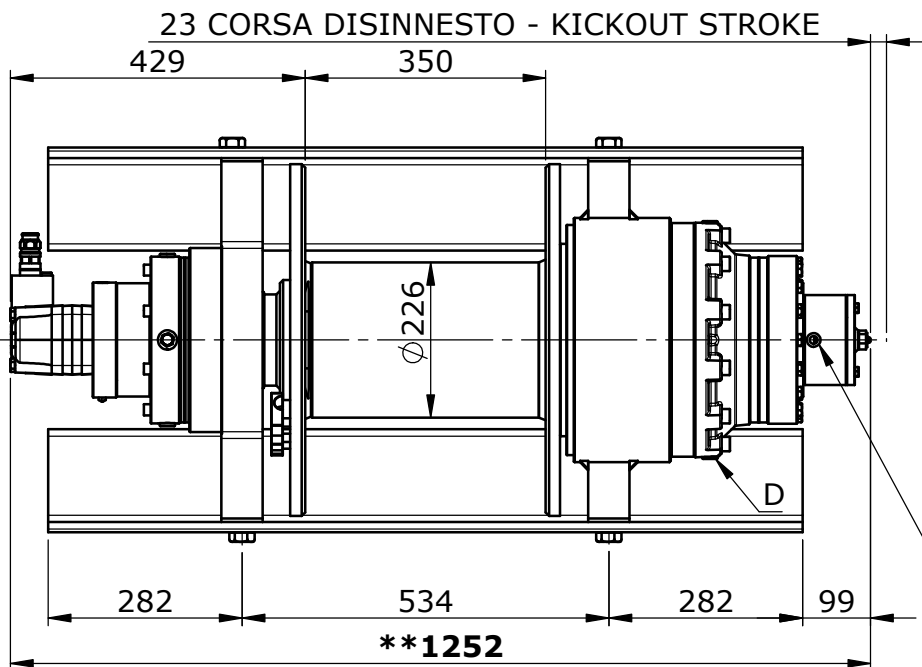

****OVERALL DIMENSIONS**

*TAMBURO PIENO / FULL DRUM

E=PNEUMATIC KICKOUT
E=DISINNESTO PNEUMATICO

PRESSIONE DI APERTURA 0.5 MPa
OPEN PRESSURE 0.5 MPa

- A HOISTING
- B LOWERING
- C DRAIN LINE
- D OIL PLUG

WEIGHT (Kg) 555.47

Model: TMT-250-160S-3-DP Code: 9.02.18.54 Class: M4 L1.T5 (FEM 1.001/1998) with drum rotation 25 rpm.

MOTOR DATA		WORKING FLOW RATE (L/min)	WORKING PRESSURE (MPa)	FLOW RATE (L/min)	MAXIMUM ALLOWED BACK PRESSURE IN HYDRAULIC RETURN LINE (MPa)	BRAKE TYPE	Braking Static Torque (daNm)	GEAR DATA	
CYL (cc)	160	75	15.0	Min 10 Max 120	0.5	Multi-disc negative brake	90	REDUCTION - RATIO	1:116.6
TYPE	ORBIT		STARTING PRESSURE					INTERNAL LUBRICATION - OIL (Kg)	5
MODEL	SU		18.5						

ROPE LAYER	N°	1	2	3	4	5		
LINE PULL (With 15 MPa)	(daN)	25000	20970	18060	15860	14140		
LINE SPEED (With 75 L/min)	(m/min)	3.1	3.7	4.2	4.8	5.4		
ROPE CAPACITY								
ROPE Ø 22 mm	(m)	11	25	41	58	78		
ROPE Ø 24 mm		10	23	38	55	73*		
ROPE Ø 25 mm		10	22	36	53	71*		

IMPORTANT
THIS WINCH IS NOT INTENDED FOR DEVICES USED FOR PERSONNEL LIFTING

Use ropes with a correct strenght.
A minimum of 5 wraps of rope must be left on drum for security.
The rated line pull are for the winch only.
We reserve the right to make changes without notice.

DATE	28/08/2019
DATI ARGANO	DA 1277.0